

Type AF Girder Clamp Guide

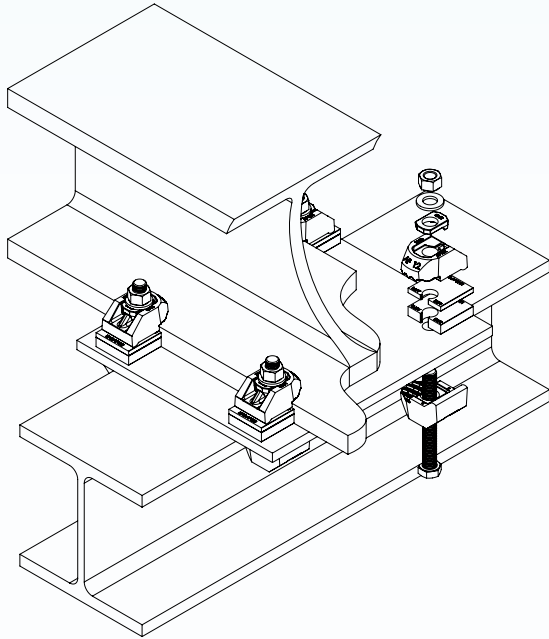

Step-by-Step Installation

- Grade 5 bolts:** Pass bolt through Type AF clamp so that the recess holds the bolt head captive. **Grade A325 / A490 bolts:** Pass bolt through AFW washer and AF clamp.
- Pass bolt through any packing pieces required (dependant on flange thickness).
- Ensuring that the clamp is perpendicular to and butted up to the edge of the lower beam flange, along with any packing pieces that the tail of the clamp will sit on, pass the bolt up through the plate.
- Place any packing pieces required (dependant on flange thickness) for the upper beam over the bolt.
- Place AF clamp and AFW washer over the bolt, ensuring perpendicular to beam and butted up against the flange.
- Place a standard washer and a standard nut on the bolt and hand-tighten.
- Assemble the remaining bolts.
- Check alignment and adjust if necessary by loosening the nuts and sliding plate along so that beams are in the correct place.
- Tighten up the nuts to the recommended tightening torque using a calibrated torque wrench.

Bolt Diameter	Tightening Torques for Grd. 5 / A325 Bolts	Tightening Torques for Grd. A490 Bolts
1/2"	66 ft lb	96 ft lb
5/8"	177 ft lb	221 ft lb
3/4"	347 ft lb	477 ft lb
1"	590 ft lb	737 ft lb

Products

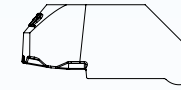
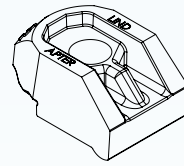

Type AF Short Tail

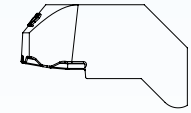
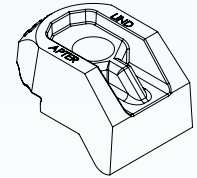

Type AF Medium Tail

Recess designed to hold the head of a standard grade 5 bolt captive.

Nose Marking

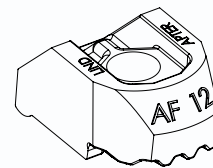

- AF12 = 1/2" Bolt
- AF16 = 5/8" Bolt
- AF20 = 3/4" Bolt
- AF24 = 1" Bolt

Type AFW Washer

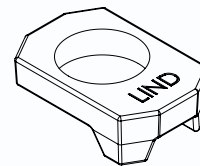

Used to fill in the recess of the AF clamp to give a flat finish.

Required:

- On the washer and nut side
- On the bolt side where A325 or A490 bolts are used

Clipped Washers (1/16" thick packing pieces)

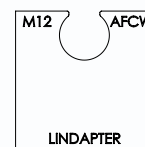

LAF050CW

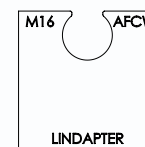

LAF062CW

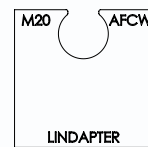

LAF075CW

P1 Packing Pieces (3/16" thick)

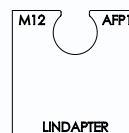

LAF050P1

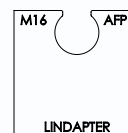

LAF062P1

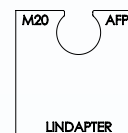

LAF075P1

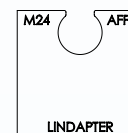

LAF100P1

P2 Packing Pieces (3/8" thick)

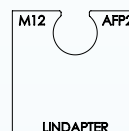

LAF050P2

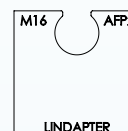

LAF062P2

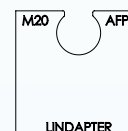

LAF075P2

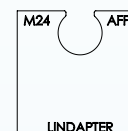

LAF100P2