

## Type A & B Girder Clamp Guide

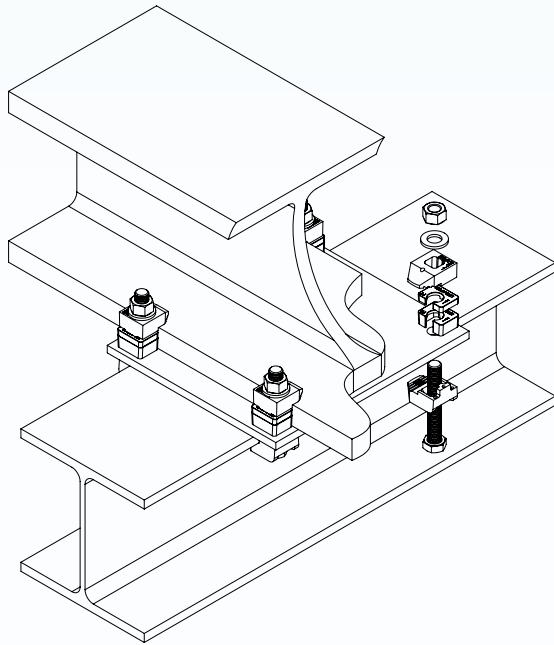

### Step-by-Step Installation

- Grade 5 bolts:** Pass bolt through Type A clamp below so that the recess holds the bolt head captive. **Grade A325 bolts:** Pass bolt through Type B clamp below.
- Pass bolt through any packing pieces required (dependant on flange thickness).
- Ensuring that the clamp is perpendicular to and butted up to the edge of the lower beam flange, along with any packing pieces that the tail of the clamp will sit on, pass the bolt up through the plate.
- Place any packing pieces required (dependant on flange thickness) for the upper beam over the bolt.
- Place Type B clamp over the bolt, ensuring perpendicular to beam and butted up against the flange.
- Place a standard washer and a standard nut on the bolt and hand-tighten.
- Assemble the remaining bolts.
- Check alignment and adjust if necessary by loosening the nuts and sliding plate along so that beams are in the correct place.
- Tighten up the nuts to the recommended tightening torque using a calibrated torque wrench.

  
**Correct**

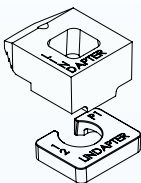

  
**Incorrect**

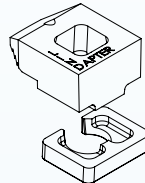

### Products

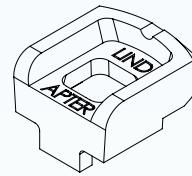

Type A Recessed

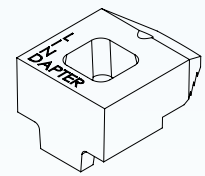

Type B Flat Top

Recess designed to hold the head of a standard grade 5 bolt captive.

### Nose Marking



1/2" Bolt



5/8" Bolt



3/4" Bolt



1" Bolt

### Tail Lengths

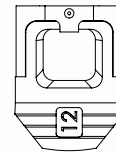

Short Tail

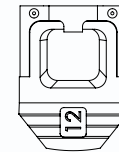

Medium Tail

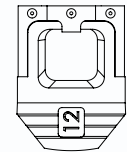

Long Tail

### Clipped Washers (packing pieces)

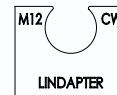

LCW050  
1/8" thick

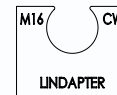

LCW062  
1/8" thick

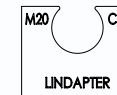

LCW075  
3/16" thick

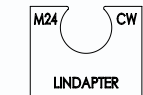

LCW100  
3/16" thick

### P1 Packing Pieces

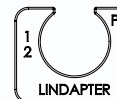

LP1050S  
1/4" thick

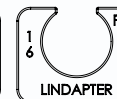

LP1062S  
5/16" thick

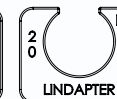

LP1075S  
3/8" thick

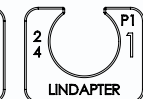

LP1100S  
1/2" thick

### P2 Packing Pieces

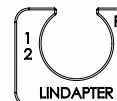

LP2050S  
1/2" thick

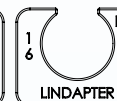

LP2062S  
5/8" thick

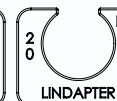

LP2075S  
3/4" thick

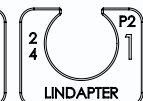

LP2100S  
1" thick

### Bolt Diameter Tightening torques for Grd. 5 / A325 Bolts

1/2"	66 ft lb
5/8"	177 ft lb
3/4"	347 ft lb
1"	590 ft lb