



Construction Supply



It's all about **Simplicity & Labor Savings**

Gripple is easier, faster, more versatile, lighter-weight, can be height adjusted and leveled, and is less labor intensive.



Our Contractors Also Love the Safety
Crew Safety, Jobsite Safety & Product Safety

“Having flexible cables hanging down rather than threaded rod, you eliminate all risk during construction and installation, especially of scissor lift operation. “

“Eliminating rework due to the cables being less prone to damage both during pre-concrete placement and during over head rough in due to the size of the toggle and flexibility of the cable in case of contact by another trade or scissor lift.”

Gripple - Building Services

For suspending Mechanical, Electrical, HVAC, Acoustic Ceilings, Lighting & Other Services

▶ APPLICATION

- What are you hanging?
- What is the weight of the service?
- What are they hanging from (type of structure)?
- How far is the service being hung from the structure?

▶ BENEFITS

- Tool Free Attachment & Adjustment
- Quick and easy installation
- Worker & Jobsite Safety
- Easy to accommodate minor misalignments

▶ FEATURES

- Available in a variety of sizes & strengths
- Comes in ready-cut lengths / Assemblies
- Wide range of end fixings for attachment to all substrates

- Up to 6 times faster to install than traditional hanging systems
- Versatile
- Simple to use
- Strong, safe and industry approved
- Aesthetically discreet and lightweight
- Supplied in ready-to-use kits, comprising a length of wire, pre-crimped End fixing, Gripple and setting key
- 5:1 safety factor typical (unless stated otherwise)

Ask for full product catalog

Submittals available upon request

More Hanging Options Available, Ask your Edge Sales Rep for other Hangers, Wire end fixings & Custom lengths

Ask about **SAMPLE** products!

Seismic rated products available

SPOKANE

1503 E. Riverside Ave.
Spokane, WA 99202
(509) 535-9841
(800) 348-4808
(509) 534-3139 (Fax)

SEATTLE

5419 Maynard Ave S.
Seattle, WA 98108
(206) 764-9488
(800) 481-TOOL (8665)
(206) 764-9487 (Fax)

YAKIMA

812 E. Mead
Yakima, WA 98903
(509) 248-1144
(800) 243-5582
(509) 575-4696 (Fax)

EUGENE

490 S. Bertelsen
Eugene, OR 97402
(541) 342-3641
(800) 944-0165
(541) 343-1753 (Fax)

MEDFORD

1789 Sage Rd.
Medford, OR 97501
(541) 779-0187
(800) 871-3919
(541) 773-4599 (Fax)

BILLINGS

120 Moore Lane
Billings, MT 59101
(406) 248-7196
(800) 272-7196
(406) 248-7269 (Fax)

GILLETTE

105 Warren Ave.
Gillette, WY 82716
(307) 682-8522
(800) 670-6851
(307) 682-8576 (Fax)

BOISE

2000 Century Way
Boise, ID 83709
(208) 377-0158
(800) 528-5118
(208) 377-0978 (Fax)

IDAHO FALLS

760 W. Broadway
Idaho Falls, ID 83402
(208) 522-7082
(208) 529-5456 (Fax)

Gripple - Standard Hanging Methods

(More options available from Gripple)

Gripple provides a wide range of wire hangers for the fast suspension of duct, pipe, conduit, cable tray, and other building systems. Our suspension kits are engineered with simplicity in-mind, ensuring you make significant savings in time and labor on your install.



Standard Hanger
Single point choke



Standard Hanger
Double point cradle

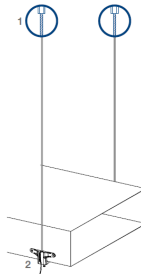

Duct Trapeze

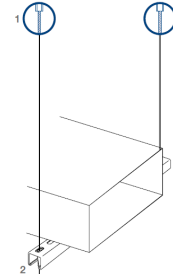

Trapeze hanger w/ struts



Standard Hanger
Single point choke

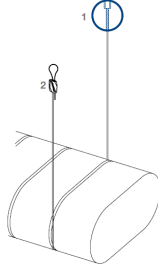

Standard Hanger
Single point choke

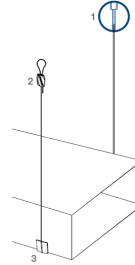

Standard Hanger
w/ Corner saddles

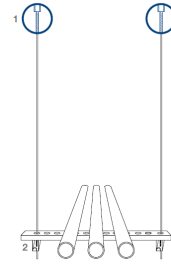

Trapeze hanger w/ struts

Standard Fitting (Available in 5 weight ratings)

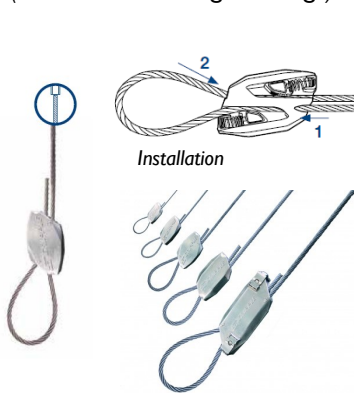

- Available Weight Ratings**
- No.1 - SWL 25 lbs
 - No.2 - SWL 100 lbs
 - No.3 - SWL 200 lbs
 - No.4 - SWL 495 lbs
 - No.5 - SWL 715 lbs

Trapeze

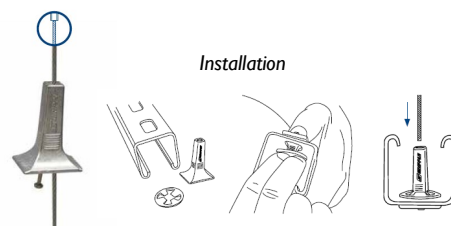

- Ideal for fast suspension of strut trapeze systems for support of rectangular duct, cable basket and ladder, conduit racks, etc.
- Slots easily into strut
- Release pin allows rapid height adjustment
- Load rated at 200 lbs with a 3:1 safety factor
- Supplied as a ready-to-use kit
- Ideal for use with the Trapeze bracket

Available Sizes

- No.2 (100 lbs per hanger)
- No.3 (200 lbs per hanger)

Duct Trapeze

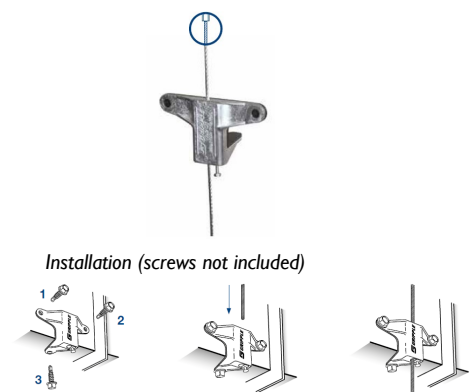

- 3 attachment points for screws
- Pin allows rapid adjustment
- Load rated at 100 lbs with a 5:1 safety factor
- Supplied as a ready-to-use kit
- Optional rubber pad available

Available Sizes

- No.2 (100 lbs per hanger)

Ask your Edge sales rep about all the other Gripple hanging options available!

Connecting to Different Substrates

(More options available from Gripple)

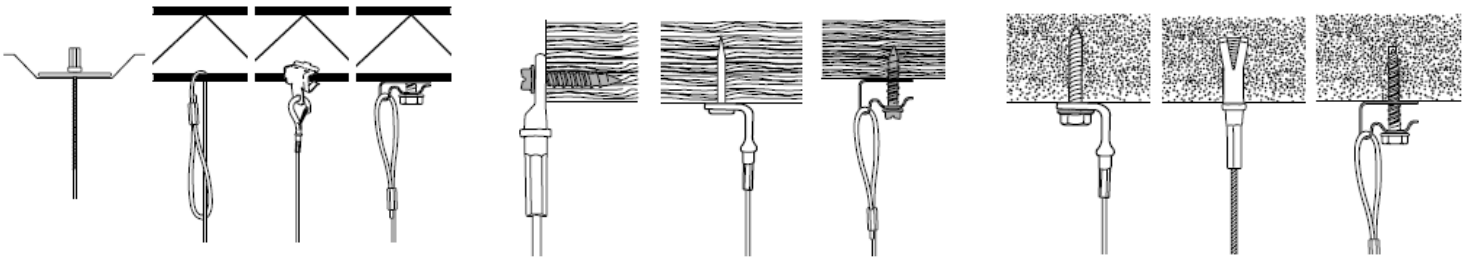

Ask your Edge sales rep about fastening to different Substrates!

Gripple - Standard Cable End Fixings

(More options Cable End Fixings from Gripple)



Loop

- Ideal for choking around bar joists, strut, purlins, beams, roof trusses and other accessible building features.
- Available up to 715 lbs SWL, with a 5:1 safety factor
- Comes as a ready-to-use kit with cable and Gripple fastener
- Available in lengths from 5 - 30 ft
- Other lengths available on request
- Available in Stainless steel



Stud

- Ideal for anchoring into concrete structures, metal decking, metal brackets using nuts, and clamps and clevis hangers.
- 1/4" and 3/8" sizes available
- Available up to 495 lbs SWL, with a 5:1 safety factor
- Comes as a ready-to-use kit with cable and Gripple fastener
- Available in cable lengths from 5 - 30 ft
- Other lengths are available on request
- Available in Stainless steel



Toggle

- Ideal for light fixtures, metal decking, and other pre-drilled structures
- Available up to 495 lbs SWL, with a 5:1 safety factor
- Comes as a ready-to-use kit with cable and Gripple fastener
- Available in cable lengths of 5 - 30 ft
- Other lengths are available on request
- Available in Stainless steel



90° Eyelet

Ask your Edge sales rep for what anchors or pins to use for each substrate

- Ideal for shot firing into concrete or steel
- Easily attached to a variety of materials using screws, bolts, gas or powder actuated tools
- Available up to 200 lbs SWL with a 5:1 safety factor
- Comes as a ready-to-use kit with cable and Gripple fastener.
- Standard cable lengths of 5 - 30 ft
- Available in 1/4", 3/8" & 1/2" eyelets
- Other lengths are available on request

Ask your Edge sales rep about all the other Gripple end fixings available!

Gripple hangers are load rated from 25 - 750 lbs per hanger, are pull tested, and have up to a 5:1 safety factors.

Gripple approvals vary by product and include:
UL, CSA, SMACNA, ICC, & MSS

Cable Construction & Cross Sections

The cable used with our product range is made of grade AISI 316 zinc galvanized, in accordance with the norm BS 302.

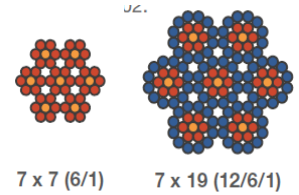

Hanger Size	Safe Working Loads (SWL)
No.1	25 lbs
No.2	100 lbs
No.3	200 lbs
No.4	495 lbs
No.5	715 lbs

Hanger Size	Diameter (inch)	Construction
No.1	1/16"	7 x 7
No.2	5/64"	7 x 7
No.3	1/8"	7 x 7
No.4	3/16"	7 x 19
No.5	1/4"	7 x 19

How to Select The Right Gripple

(Custom Gripple Hangers, End Fittings & Cable Lengths available)

Step 1: Choose your Gripple hanger type & weight to meet your specifications

First section of part number

Hanger Type	No.1 (25lbs)	No.2 (100 lbs)	No.3 (200 lbs)	No.4 (495 lbs)	No.5 (715 lbs)
Standard Gripple (HF)	HF1	HF2	HF3	HF4	HF5
Trapeze (TZ)	N/A	TZ2	TZ3	N/A	N/A
Duct Trapeze ((DT)	N/A	DT2	N/A	N/A	N/A

N/A: Not available in this wire weight rating

Step 2: Choose your Gripple end fixing

Second section of part number

Hanger Type	No.1 (25lbs)	No.2 (100 lbs)	No.3 (200 lbs)	No.4 (495 lbs)	No.5 (715 lbs)
Loop	LG	LG	LG	LG	LG
Toggle	TG	TG	TG	TG	N/A
90° Eyelet*	EY*	EY*	EY*	N/A	N/A

* Available in different Eyelet size: 1/4" = QG, 3/8" = 3/8G, 1/2" = HG (added to end Part # section)

Step 3: Choose your Gripple wire length

Last section of part number

Wire Length (pre-cut)	Part # Designation
5 foot wire	5FT
10 foot wire	10FT
15 foot wire	15FT
20 foot wire	20FT
30 ft wire	30FT

EXAMPLE

You are hanging Spiral Duct from metal decking using a standard Gripple hanger with a 90° 3/8" eyelet hole, hanging 10 feet from the deck and need to meet a 200 lb weight rating.

Your Pre-Configured kit part number would read:

GPHF3-EY903/8G-10FT

